

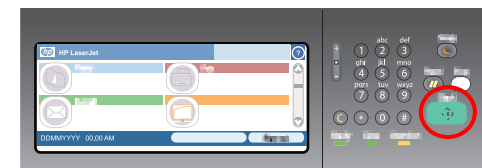

E-mail my scan

How do I?	Steps to perform
Send to e-mail	<ol style="list-style-type: none"><li data-bbox="720 347 1323 403">1 Place the sheets face-up into the document feeder, and adjust both paper guides against the document.<li data-bbox="720 576 1323 632">2 Touch E-mail. If prompted, type your user name and password.<li data-bbox="720 756 1323 812">3 Touch the From field, and type your e-mail address. Touch the To field.<li data-bbox="720 936 1323 992">4 Type the e-mail address. Touch the down arrow next to To. Touch Subject, and type the text. Touch OK.<li data-bbox="720 1117 896 1145">5 Press Start.

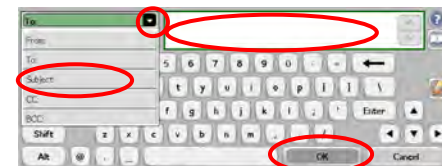

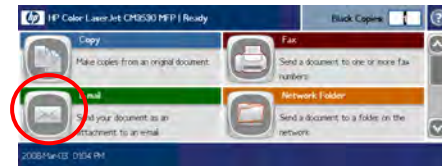
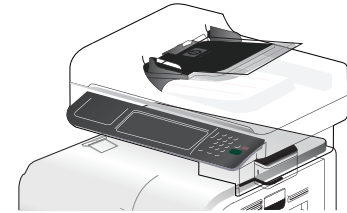

Use the address book

How do I?	Steps to perform	
<p>Access the address book</p>	<ol style="list-style-type: none"> 1 Touch E-mail. If prompted, type your user name and password. 2 Touch the address book button 	
<p>Add a name to the address book</p>	<ol style="list-style-type: none"> 3 Touch the plus (+) button. 4 Type the name and touch OK. 5 Type the e-mail address and touch OK. 6 Touch OK to save the address book entry. 	



HP Color LaserJet CM3530 MFP Series – Scan



Send my scan to a folder

How do I?

Scan to a network folder

Steps to perform

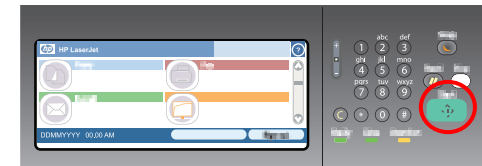
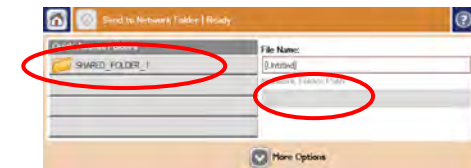
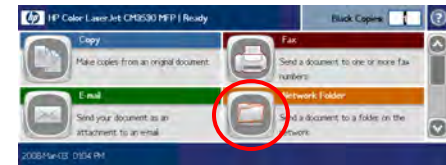
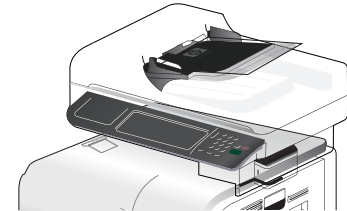

- 1 Place the sheets face-up into the document feeder, and adjust both paper guides against the document.
- 2 Touch **Network Folder**.
- 3 Select the folder in which you want to save the document. Or, touch **Network Folder Path** to open the keyboard, and then type the folder path. Touch **OK**.
- 4 Touch **File Name** to open the keyboard, and then type the file name. Touch **OK**.
- 5 Press **Start**.



HP Color LaserJet CM3530 MFP Series – Scan



Make my scan look better

How do I?	Steps to perform
Clean the scanner glass	<p>Clean the scanner glass by wiping it gently with a clean, slightly damp, lint-free cloth. Use an ammonia-based surface cleaner only when a water-dampened cloth does not clean the scanner glass.</p> 
Clean the document feeder	<p>Clean the document-feeder backing by wiping it with a clean, damp, lint-free cloth. Use an ammonia-based surface cleaner only when a water-dampened cloth does not clean the components.</p> 
Adjust scan quality Note: This procedure applies to any type of scanned document including copying, sending to e-mail, sending to a network folder, or faxing.	<ol style="list-style-type: none">1 Touch the appropriate feature on the control panel.2 Touch Image Adjustment.3 Adjust the Darkness setting to increase or decrease the amount of black.4 Increase the Background Cleanup setting to remove faint images from the background or to remove a background color. Decrease the Background Cleanup setting if you are having trouble copying a faint image on the page.5 Adjust the Sharpness setting to clarify or soften the image. For example, increasing the sharpness could make text appear crisper, but decreasing it could make photographs appear smoother. 