



Product End-of-Life Disassembly Instructions

Product Category: Personal Computers

Marketing Name / Model
[List multiple models if applicable.]

Name / Model #1 HP dx2810/2818 Desktop PC

Name / Model #2

Name / Model #3

Name / Model #4

Name / Model #5

Purpose: The document is intended for use by end-of-life recyclers or treatment facilities. It provides the basic instructions for the disassembly of HP products to remove components and materials requiring selective treatment, as defined by EU directive 2002/96/EC, Waste Electrical and Electronic Equipment (WEEE).

1.0 Items Requiring Selective Treatment

1.1 Items listed below are classified as requiring selective treatment.

1.2 Enter the quantity of items contained within the product which require selective treatment in the right column, as applicable.

Item Description	Notes	Quantity of items included in product
Printed Circuit Boards (PCB) or Printed Circuit Assemblies (PCA)	With a surface greater than 10 sq cm	1(M/B) 1(PSU)
Batteries	All types including standard alkaline and lithium coin or button style batteries	1(On M/B)
Mercury-containing components	For example, mercury in lamps, display backlights, scanner lamps, switches, batteries	0
Liquid Crystal Displays (LCD) with a surface greater than 100 sq cm	Includes background illuminated displays with gas discharge lamps	0
Cathode Ray Tubes (CRT)		0
Capacitors / condensers (Containing PCB/PCT)		0
Electrolytic Capacitors / Condensers measuring greater than 2.5 cm in diameter or height		2(PSU)
External electrical cables and cords		0
Gas Discharge Lamps		0
Plastics containing Brominated Flame Retardants weighing > 25 grams (not including PCBs or PCAs already listed as a separate item above)		0
Components and parts containing toner and ink, including liquids, semi-liquids (gel/paste) and toner	Include the cartridges, print heads, tubes, vent chambers, and service stations.	0
Components and waste containing asbestos		0

Components, parts and materials containing refractory ceramic fibers		0
Components, parts and materials containing radioactive substances		0

2.0 Tools Required

List the type and size of the tools that would typically be used to disassemble the product to a point where components and materials requiring selective treatment can be removed.

Tool Description	Tool Size (if applicable)
Electric driver with Torx driver bit No. 15	
manual Torx driver No. 15 (alternate tool)	
Philips Screw Driver	
Flat head screw driver	
Description #5	

3.0 Product Disassembly Process

3.1 List the basic steps that should typically be followed to remove components and materials requiring selective treatment:

1. M/B Battery Removal
2. Remove the cables on the MB
3. Remove the screws from the MB
4. Locate the MB battery on the system board. With a medium flat head screw driver, to remove the battery and dispose of properly.
5. PSU capacitors removal
6. Remove the PSU from the chassis by using a torx T15 screw driver.
7. With #2 Philips screw driver to remove the screws on the PSU and open the top cover.
8. Locate the capacitors and pry from the PCB with a medium flat head screw driver and dispose of properly.

3.2 Optional Graphic. If the disassembly process is complex, insert a graphic illustration below to identify the items contained in the product that require selective treatment (with descriptions and arrows identifying locations).

1. Disassembly Diagram

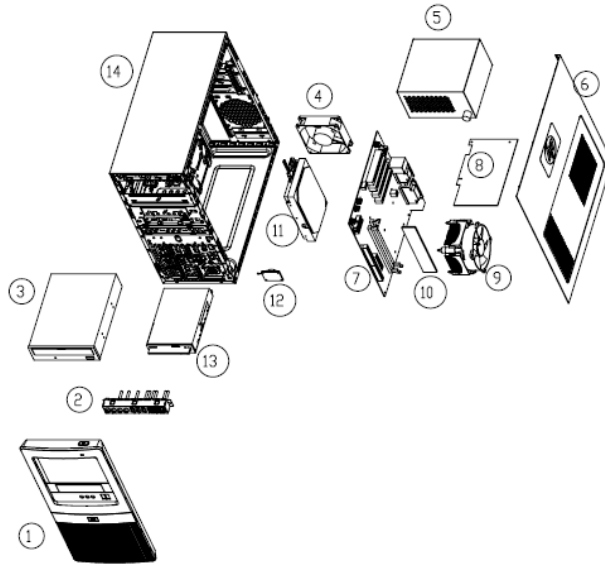

2. System Battery Location

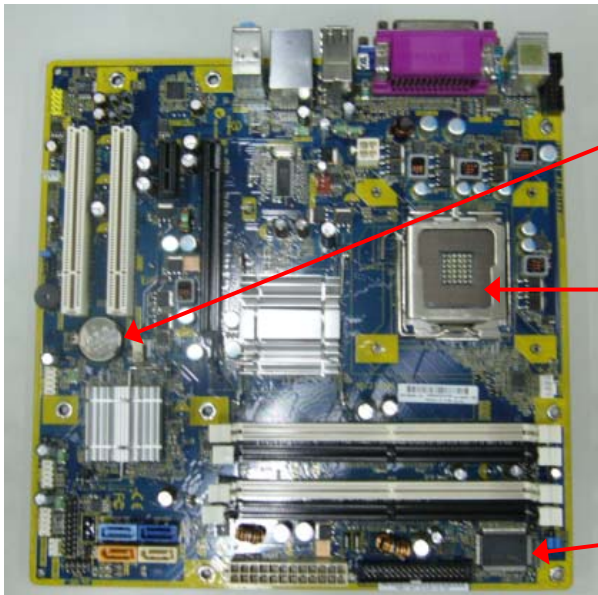

Battery
removed from Holder

Processor
removed

Lifted out MB
from the Chassis

3. PSU Capacitor Locations

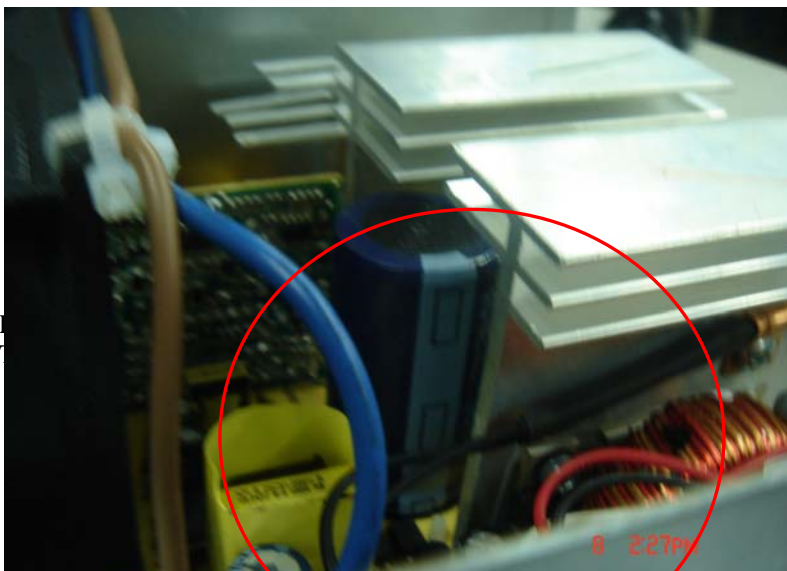

Available at [EL-MF877-01](#)

